

MICROFILMED

NORTH BRACKWOOD DRIVE
WATER & SEWER IN ST. 112

FILED
GREENVILLE CO. S.C.
JAN 21 11 58 AM 1986
DONNIE S. TANNEY
R.M.C.

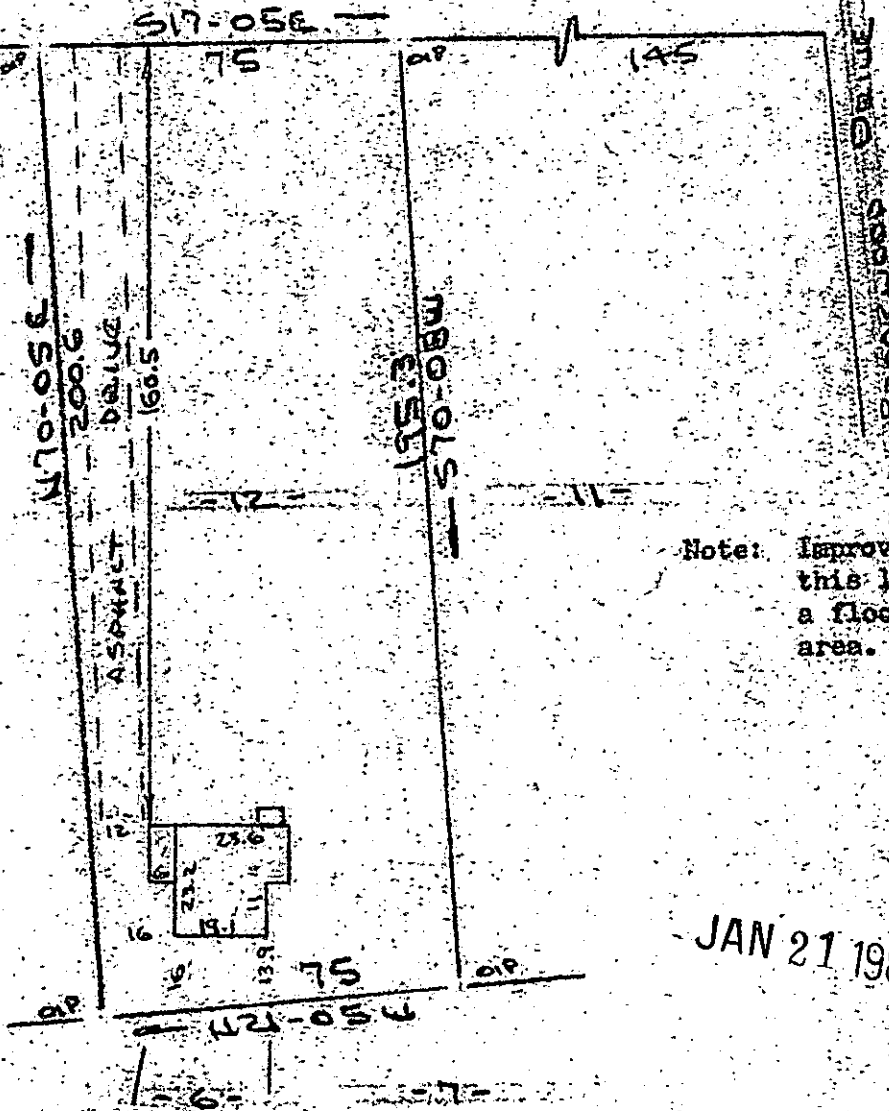

Note: Improvements on this lot are not in a flood hazard area.

JAN 21 1986

PROPERTY OF
BENNETT R. SKELTON
CITY OF GREENVILLE, S.C.
SCALE 1"=40' 13 JAN 1986

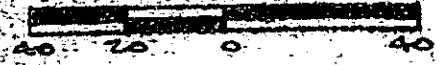

This is to certify that on the 13th day of January, 1986, I surveyed the property shown on this plat, being known as lot 12 on plat of MAP OF PARK HILL and recorded in the REC Office Greenville County, S. C., in Plat Book " J " at Pages 208 & 209; and that the property lines, walls and buildings are as shown hereon, and that the walls and buildings located on said lot do not encroach or project on adjacent street or property, and that no adjacent walls or buildings encroach or project on said premises, and no power lines cross this property except as shown hereon.

12-I-31

24089

R. B. Bruce
R. B. Bruce, RLS # 1952

CAROLINA SURVEYING
Greenville, S.C.

Recordable Plat